

# COMPLETING YOUR CIRCLE OF JOY.

**Jewel Homes**  
PRIVATE LIMITED

Home  
for  
Ever

**JEWEL**  
**Radius**  
LIFESTYLE APARTMENTS  
Vazhakkala

**31<sup>st</sup>**  
Project

Welcome to a home that presents the finest prospects. Jewel Radius offers 1 and 2 BHK Apartments in close proximity to the NH Bypass at Vazhakkala. Enjoy the benefits of comfort, choice and connectivity at one of the most sought after residential locations in Cochin.

Home  
for  
Ever

JEWEL  
**Radius**  
LIFESTYLE APARTMENTS  
Vazhakkala



[www.jewelhomes.net](http://www.jewelhomes.net)

**Jewel Homes**  
PRIVATE LIMITED



TYPE - A : 2 Bed  
 1st to 9th Floor  
 Area : 1069 sq.ft

www.jewelhomes.net



Home for Ever

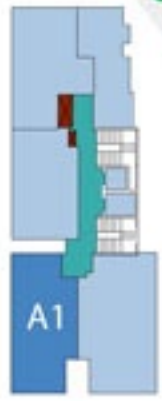

TYPE - A1 : 2 Bed  
10th and 11th Floor  
Area : 856 sq.ft

www.jewelhomes.net



JEWEL  
**Radius**  
LIFESTYLE APARTMENTS  
Vazhakkala

  
**Jewel Homes**  
PRIVATE LIMITED



TYPE - B : 2 Bed  
 1st to 9th Floor  
 Area : 1069 sq.ft



[www.jewelhomes.net](http://www.jewelhomes.net)



Home  
for  
Ever



TYPE - B1 : 2 Bed  
10th and 11th Floor  
Area : 1026 sq.ft



JEWEL  
**Radius**  
LIFESTYLE APARTMENTS  
Vazhakkala

www.jewelhomes.net

  
**Jewel Homes**  
PRIVATE LIMITED

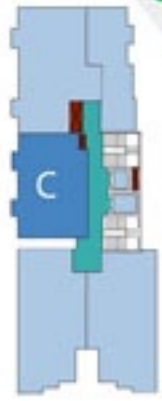

TYPE - C : 2 Bed  
 1st to 9th Floor  
 Area : 895 sq.ft



www.jewelhomes.net



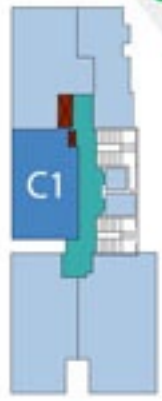

TYPE - C1 : 2 Bed  
 10th and 11th Floor  
 Area : 736 sq.ft



www.jewelhomes.net







TYPE - D : 2 Bed  
 1st to 9th Floor  
 Area : 1067 sq.ft

[www.jewelhomes.net](http://www.jewelhomes.net)



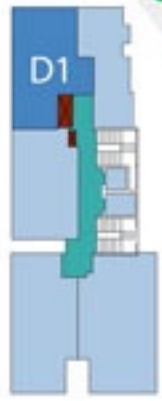

**TYPE - D1**  
 1 Bed with Study  
 10th and 11th Floor  
 Area : 807 sq.ft



[www.jewelhomes.net](http://www.jewelhomes.net)



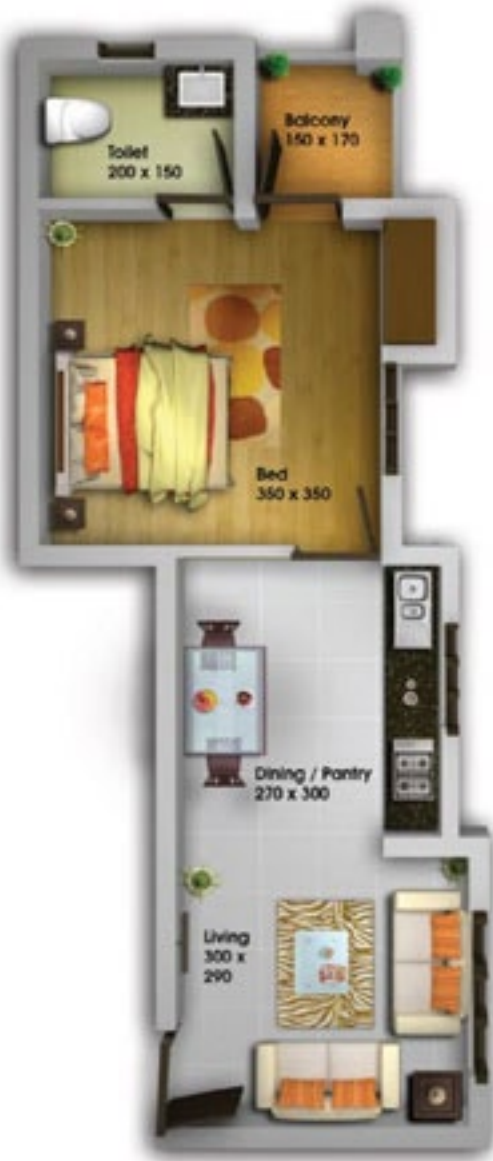

TYPE - E : 1 Bed  
 1st to 9th Floor  
 Area : 579 sq.ft

**JEWEL**  
**Radius**  
 LIFESTYLE APARTMENTS  
 Vazhakkala

[www.jewelhomes.net](http://www.jewelhomes.net)

**Jewel Homes**  
 PRIVATE LIMITED

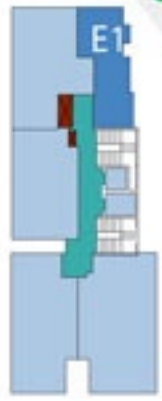

TYPE - E1 : 1 Bed  
10th and 11th Floor  
Area : 525 sq.ft

JEWEL  
**Radius**  
LIFESTYLE APARTMENTS  
Vazhakkala

www.jewelhomes.net



# Specifications

Home  
for  
Ever

- Foundation** : Resilient and robust, our foundations are deep R.C.C piled penetrating to requisite strata
- Structure** : Strongly Reinforced Cement Concrete blocks are used to frame our structures which ensure durability
- Walls** : Premium quality concrete solid/ hollow blocks are used to build fill walls preventing cracks and fissures effectively
- Wall finish** : Our external walls use superior cement mortar plastering and weather coat finish to ensure aesthetic appeal. Internal walls are finely putted and rendered emulsion paint finish.
- Doors & Windows** : The front doors are crafted in premium quality Hardwood. Exquisitely moulded panel doors are used for interiors. Windows have been crafted of powder coated aluminium with M.S grills and glass panes.
- Flooring** : Magnificent vitrified tiled flooring designs are devised for apartments, ground floor lobby, passages and main staircase
- Kitchen** : Kitchen with counter top slab and dadoing for easy fit out of cabinets.
- Toilets** : Pleasantly designed, our toilets have 6 feet high ceramic

## Specifications

Home  
for  
Ever

glazed tiles. Bathrooms in master bedrooms have an inbuilt space for Geyser with power and water connection points. Other features are premium quality wash basins, concealed / open closets(Cera or equivalent), chromium plated taps and shower fixtures( Marc or equivalent).

**Electrical connectivity :** Safe and well equipped, our apartments have three phase power connectivity with concealed wiring controlled by ELCB/ MCB. Syncing well with the interiors, we have elegant modular switches( Crabtree or equivalent). The master bedroom has provision for split A/C.

**Water connection :** To ensure absolutely nil inconvenience, water supply will be available around the clock through sump and overhead tanks. Drinking water will be available from a KWA line in the kitchen. In case of an immediate requirement, provisions have been made to draw water from the well too.

**Entertainment & Communication :** Keeping pace with times, provisions for all sorts of connectivity has been ensured at our apartments. Telephone and TV line connectivity has been provided for in the drawing room & master bedroom. So has docks for internet connectivity been provided too.

**Car Parking :** We have adequate parking facility within the project. You will be required to pay an extra cost determined for the same.



# Amenities

Home  
for  
Ever



- Fitness Zone
- Indoor Recreation Area
- Outdoor Play Area for Children
- Intercom
- CCTV Surveillance at Parking/Lobby
- Piped Cooking Gas Connections
- Power Backup
- 24 x 7 Security Coverage
- Fire Control Equipments
- Sewage Treatment Facility
- Rainwater Harvesting
- Separate Lifts for Passenger Carriage and Service Purposes
- Separate Restrooms for Drivers and Housemaids

JEWEL  
**Radius**  
LIFESTYLE APARTMENTS  
Vazhakkala

www.jewelhomes.net

  
**Jewel Homes**  
PRIVATE LIMITED

# Location

## With In Your Radius

Located at Vazhakkala, Jewel Radius is at the heart of the entire buzz. Jewel Radius is at a stone's throw away from the NH Bypass and so will be a home that will guarantee you direct link to almost all facilities. Be it schools, colleges, major commercial hubs, shopping malls or hospitals. Every need is within your radius at this home.

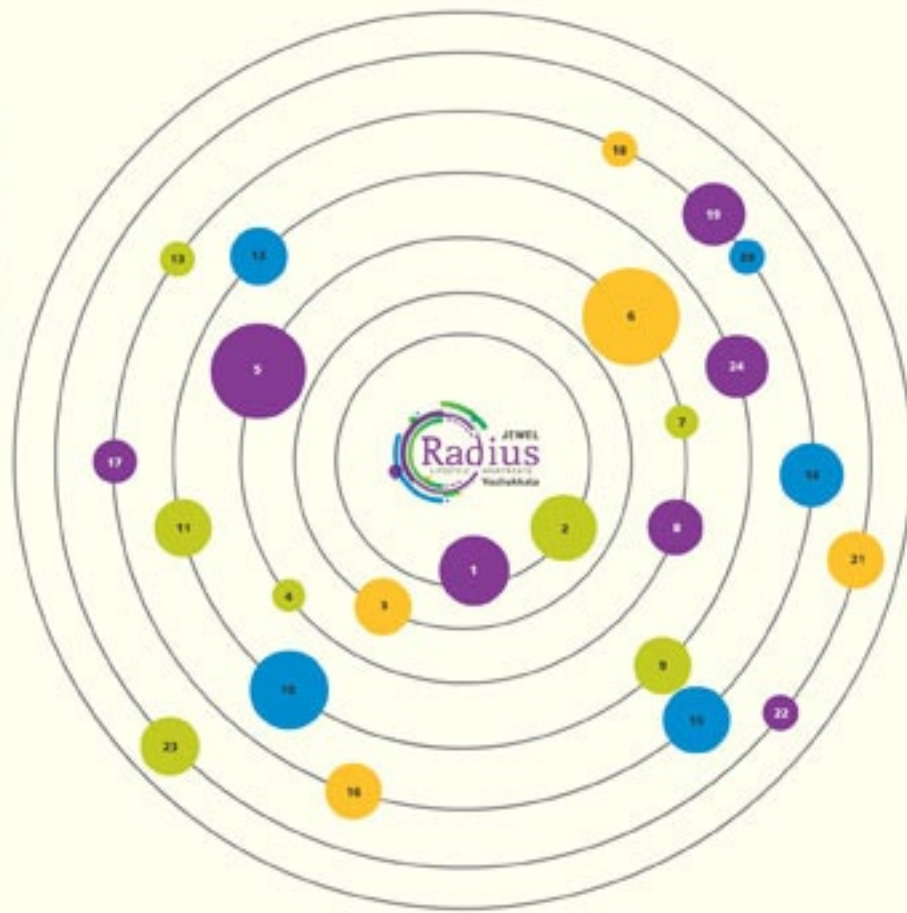

1. Mary Matha Higher Secondary School
2. Mary Matha Kindergarten
3. Assisi Vidyaniketan Public School
4. Oberon Mall
5. Edappally Junction
6. St. Joseph L.P. School
7. Nava Nirman Public School
8. Bhavan's Varuna Vidyalaya
9. Cochin Special Economic Zone
10. Pipeline Junction
11. Renai Medicity Hospital
12. LuLuMall
13. Al Ameen Public School
14. Sunrise Hospital
15. Bhavans Adarsha Vidyalaya
16. Ernakulam Medical Centre
17. Edappally Government High School
18. ESI Dispensary
19. Model Engineering College
20. Bharatamatha College
21. Primary Health Centre
22. Modern Public School
23. Palarivattom
24. Kottakkal Arya Vaidya Sala Hospital

www.jewelhomes.net





## Contact Us

Home  
for  
Ever



CREDAI  
Kerala



  
**Jewel Homes**<sup>®</sup>  
PRIVATE LIMITED

**Kochi:** 'Casagrante' building, 2nd Floor  
Deshabhimani Jn. Kaloor, Kochi - 682 017  
**Tel: +91 484 2335315, 2348856, 4020209**

**Kottayam:** Trio Chambers, Opp. SBT  
Kanjikkuzhi, Kottayam - 686 004, **Tel: +91 481 2573124**

e-mail: [sales@jewelhomes.net](mailto:sales@jewelhomes.net)

web: [www.jewelhomes.net](http://www.jewelhomes.net)

**Call** +91 98460 20209, 98476 20209

JEWEL  
**Radius**  
LIFESTYLE APARTMENTS  
Vazhakkala

[www.jewelhomes.net](http://www.jewelhomes.net)

  
**Jewel Homes**<sup>®</sup>  
PRIVATE LIMITED